

April 2024

Click the button  
to watch the  
assembly video

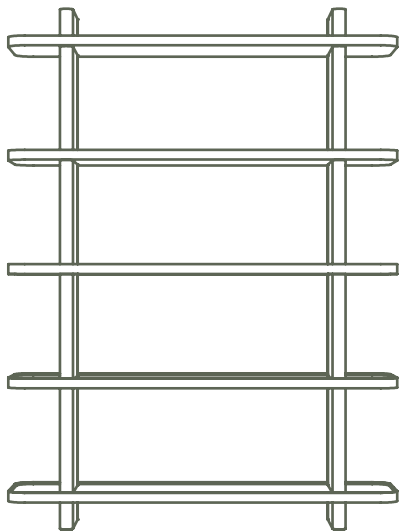

TALL & WIDE  
KIRRIBILLI BOOKSHELF



Click the button  
to watch the  
assembly video



# What's in the box\*:

\*Not to scale

**2x**

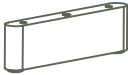

bottom upright panel

**2x**



top upright panel

**8x**



shelf upright panels

**4x**

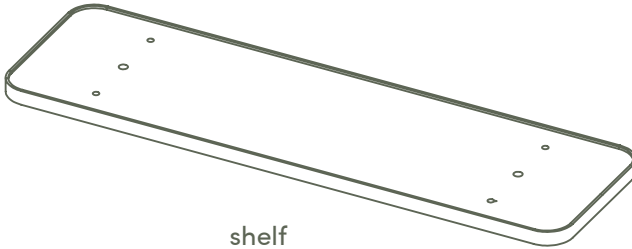

shelf

**4x**



rod

**20x**



dowel

**1x**

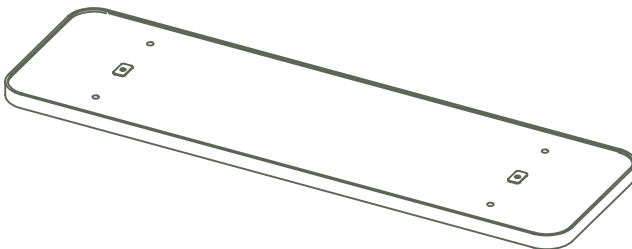

top shelf

**2x**

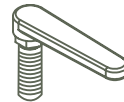

lever bolt

**2x**

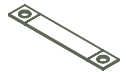

wall mount  
lanyard

# 1. place dowels into bottom upright panels

Click the button  
to watch the  
assembly video

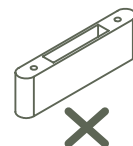
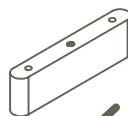
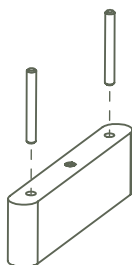
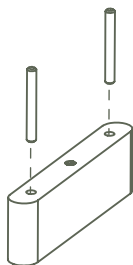

# 2. place shelf onto bottom upright panels using dowels to align

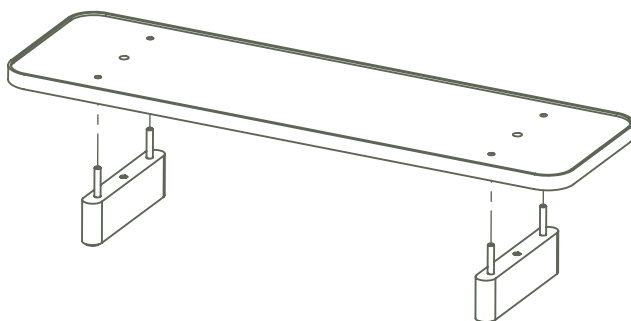

**NOTE** - Make sure lip is facing up.

### 3. screw in rods to bottom upright panels

Click the button  
to watch the  
assembly video

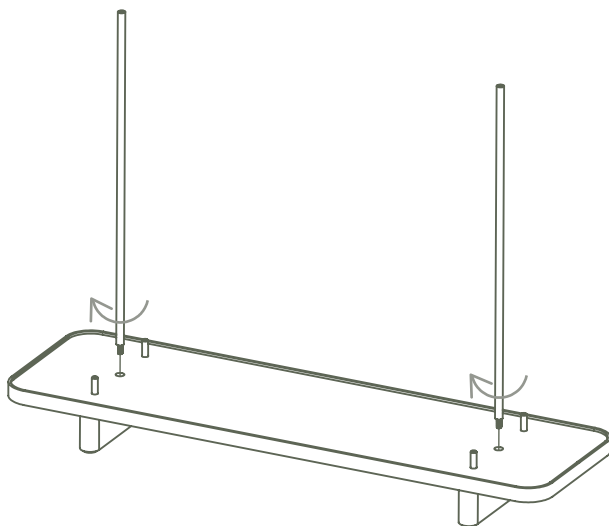

---

### 4. slide shelf upright panels over rods onto bottom shelf

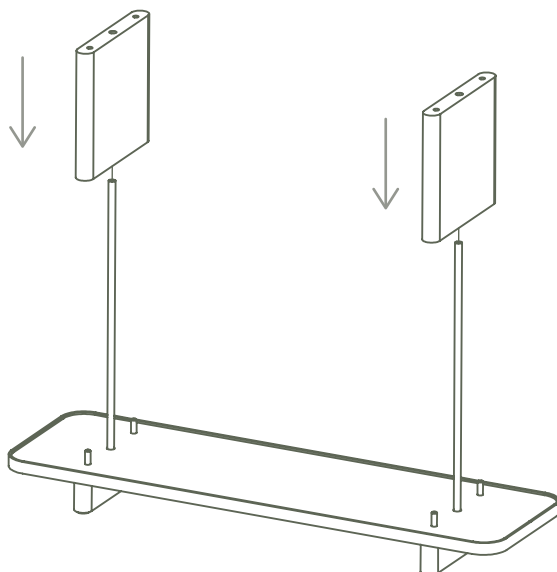

**5.** slide next shelf onto shelf uprights over rods

Click the button  
to watch the  
assembly video

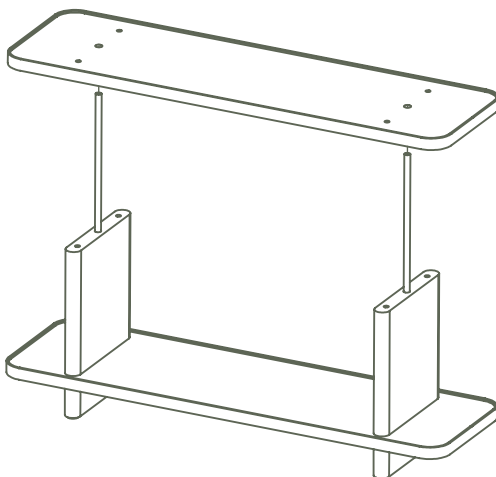

**NOTE** - Make sure lip is  
facing up.

---

**6.** place dowels into shelf holes making sure they go through  
into the shelf upright panels below

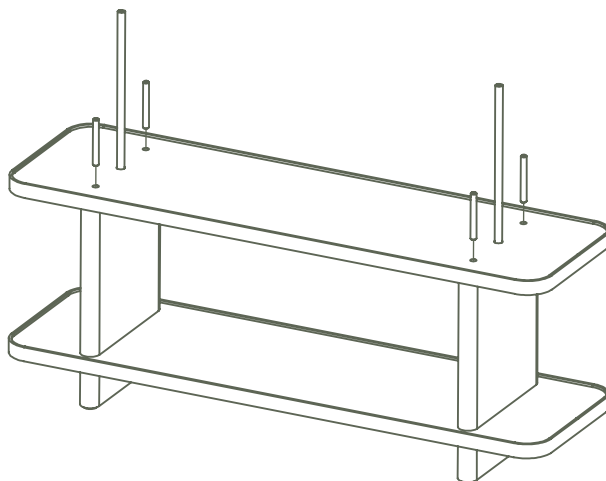

7.

slide next shelf upright panels over rods  
onto bottom shelf

Click the button  
to watch the  
assembly video

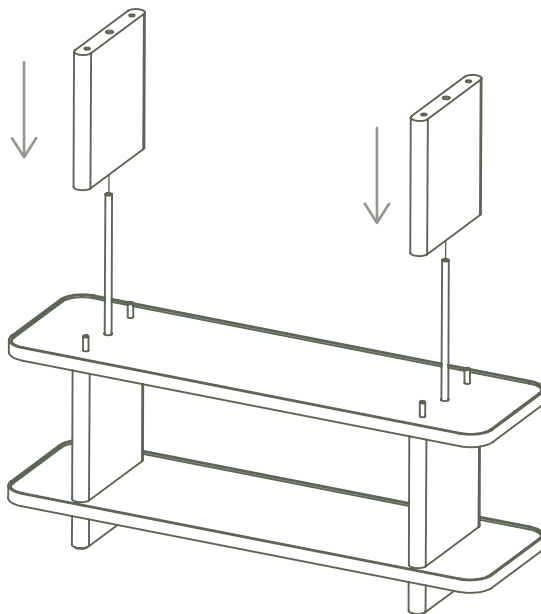

8.

slide next shelf onto shelf uprights over rods

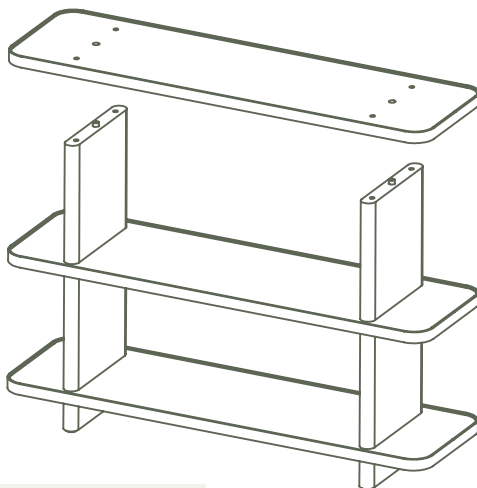

NOTE - Make sure lip is  
facing up.

- 9.** place dowels into shelf holes making sure they go through into the shelf upright panels below

Click the button  
to watch the  
assembly video

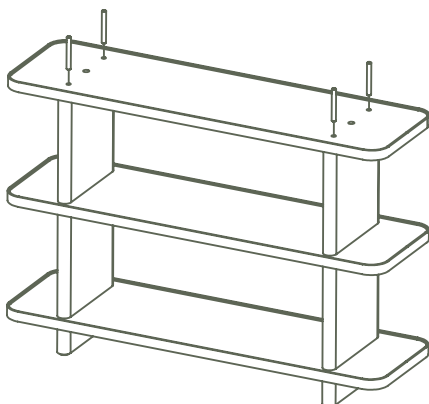

- 
- 10.** screw in the remaining rods into the lower rods

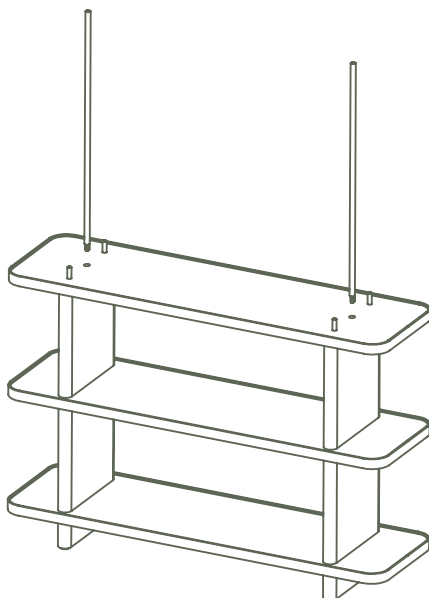

## 11. slide next shelf upright panels over rods onto bottom shelf

Click the button  
to watch the  
assembly video

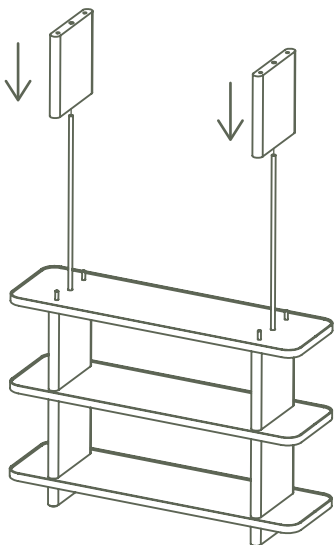

---

## 12. slide next shelf onto shelf uprights over rods

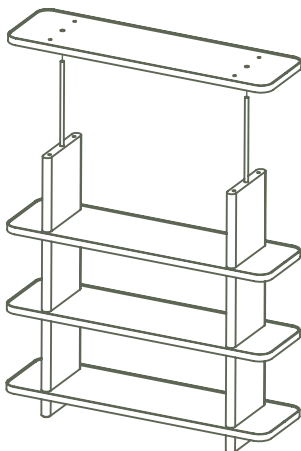

**NOTE** - Make sure lip is facing up.

- 13.** place dowels into shelf holes making sure they go through into the shelf upright panels below

Click the button  
to watch the  
assembly video

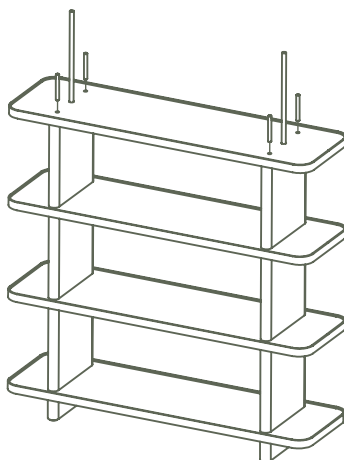

- 
- 14.** slide next shelf upright panels over rods onto bottom shelf

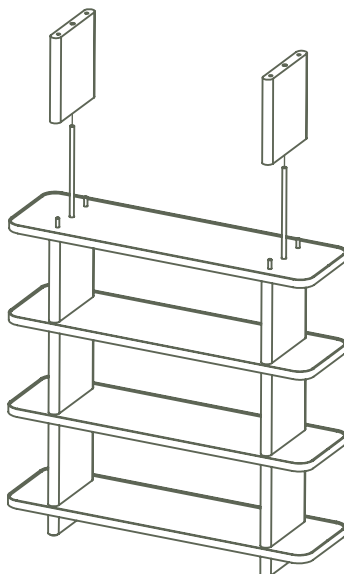

**15.** place dowels into the shelf upright panel holes

Click the button  
to watch the  
assembly video

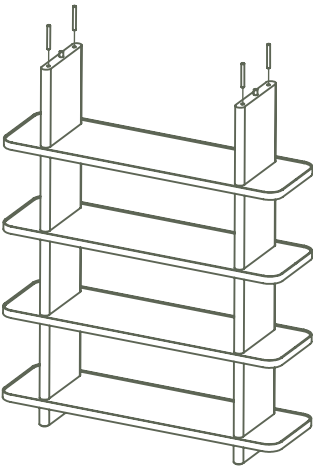

**16.** install the wall mounting lanyards by threading the eyelet through the dowel

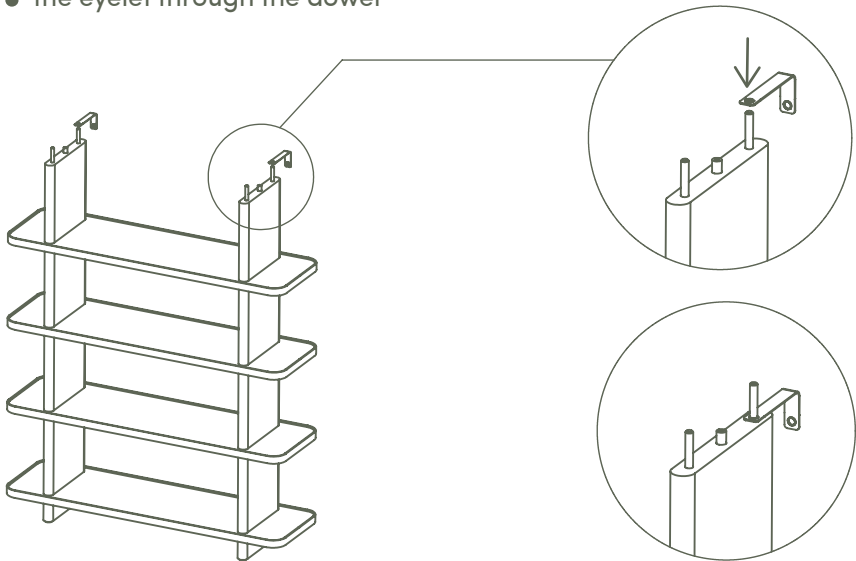

17.

slide final shelf onto shelf uprights over rods

Click the button  
to watch the  
assembly video

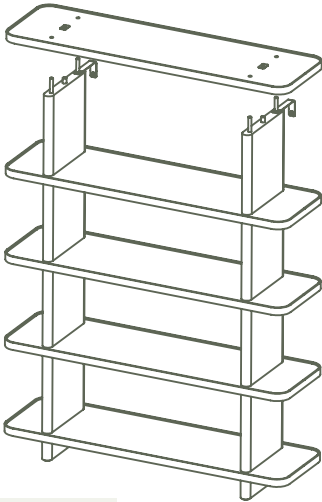

NOTE - Make sure  
lip is facing up.

18.

screw lever bolts into the top of the rods

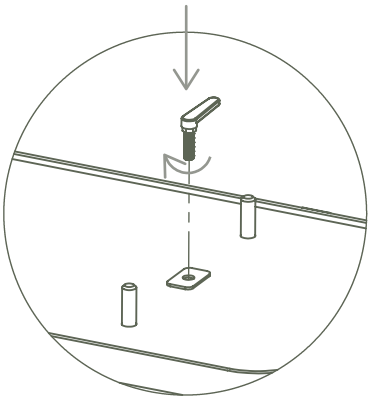
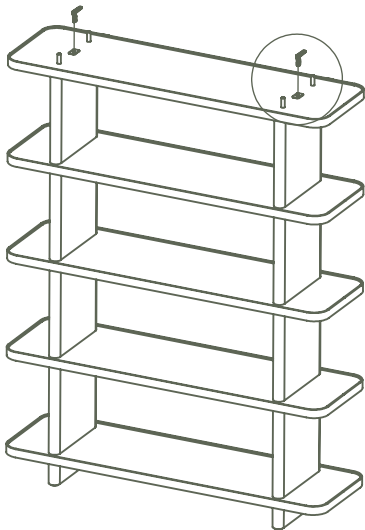

**19.** once both lever bolts are tightened,  
lift and rotate the lever so that it is  
pointing at a dowel

Click the button  
to watch the  
assembly video

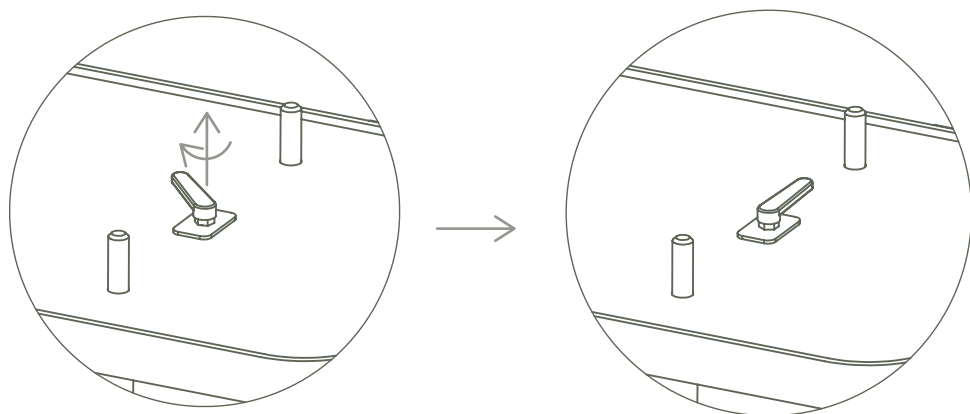

---

**20.** lower the top upright panels onto the top shelf using the  
dowels to locate

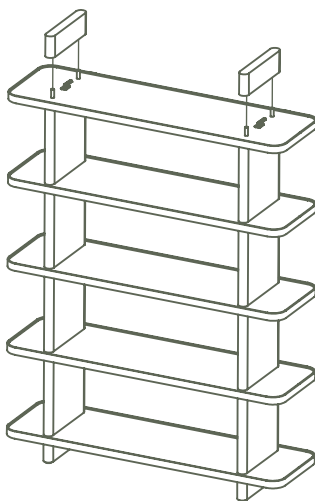

## **⚠ WARNING**

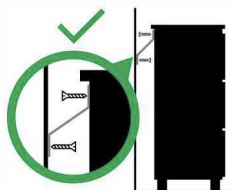

### **Children have died from furniture tipover.**

- ALWAYS secure this furniture with an anchor device.
- NEVER allow children to stand, climb or hang on drawers, doors, or shelves.
- NEVER open more than one drawer at a time.
- Place heavy items down low.

**NEVER put a TV on this furniture**



Click the button  
to watch the  
assembly video

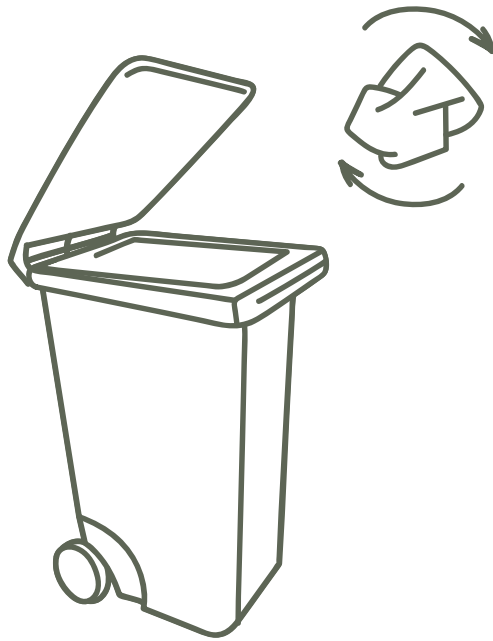

don't forget to recycle.

**ko'ala**