

# Kirribilli Bed

## Single & King Single

Click the button  
to watch the  
assembly video

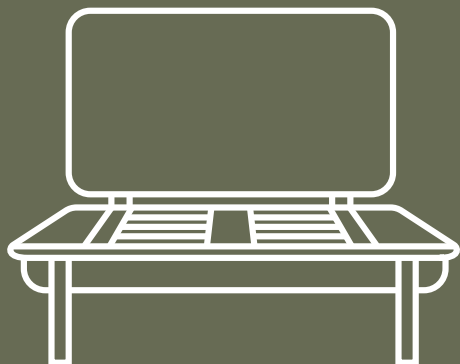

o  
/  
o  
'  
o  
Y

# What's in the box\*

\*Not to scale



**x2**

Head end leg



**x2**

End support panel



**x2**

Bedhead bracket



**x2**

Foot end Leg

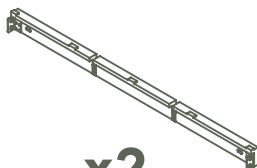

**x2**

Side support panel

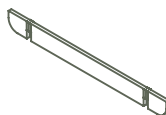

**x2**

Middle support frame

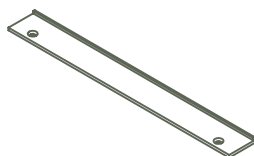

**x2**

Side platform

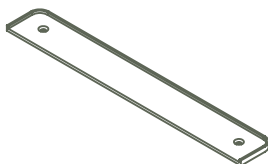

**x2**

End platform

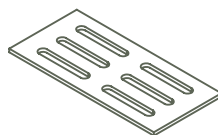

**x4**

Base platform

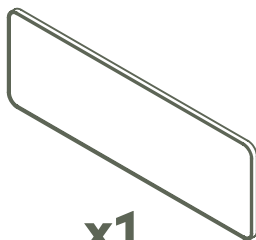

**x1**

Bedhead



**x8**

Tapered  
Gumnut



**x4**

Bedhead  
Gumnut



**x4**

Leg Gumnut

Pre-assembly check

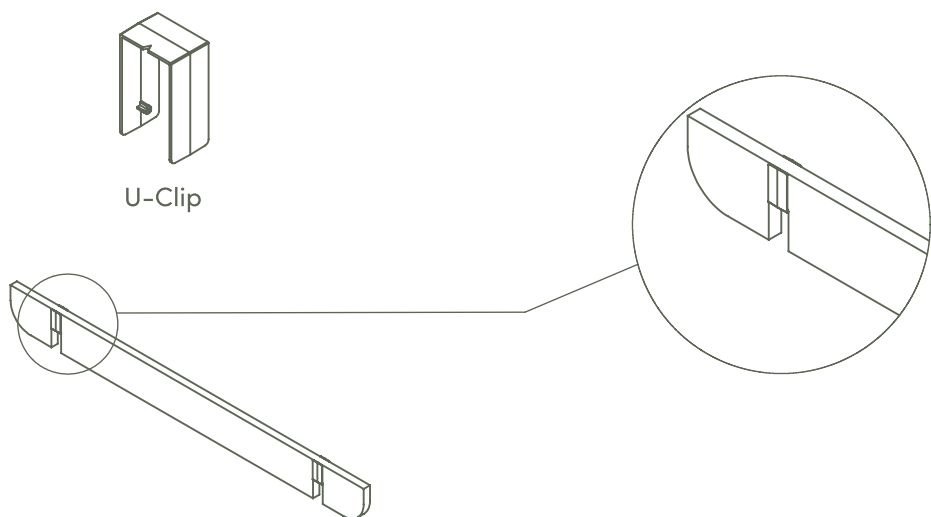

NOTE - Do not remove u-clip from any of the panels

Lay out all parts in the desired orientation for the room

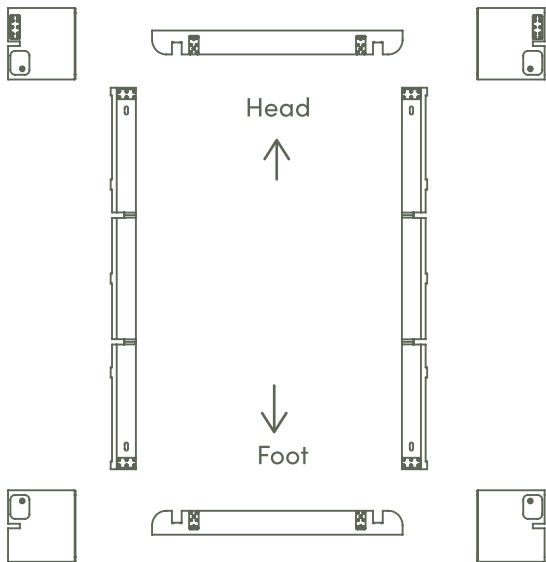

# 1. Slot head-end legs onto the end support panel

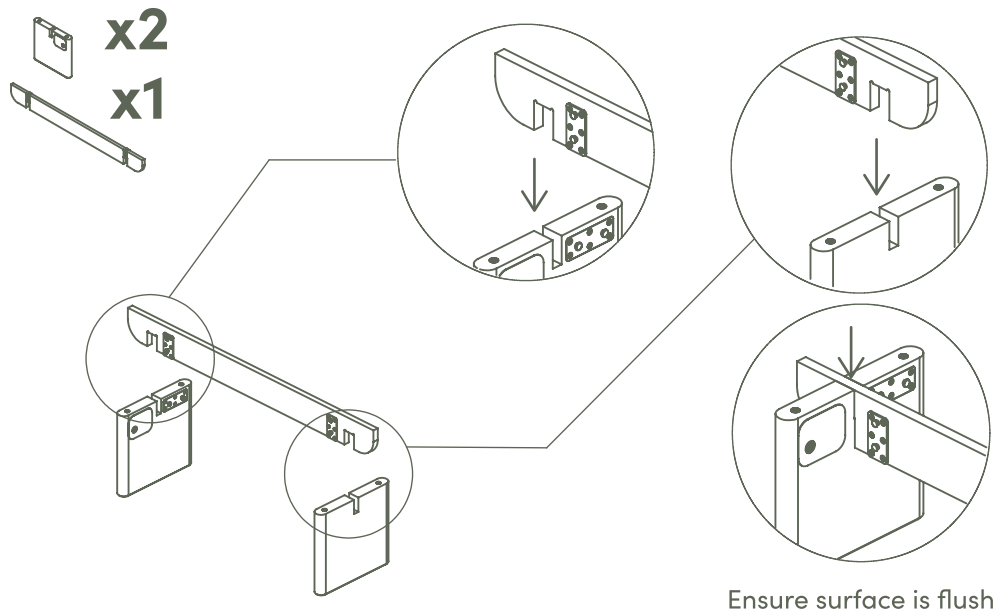

# 2. Attach the bedhead brackets onto the end support panel

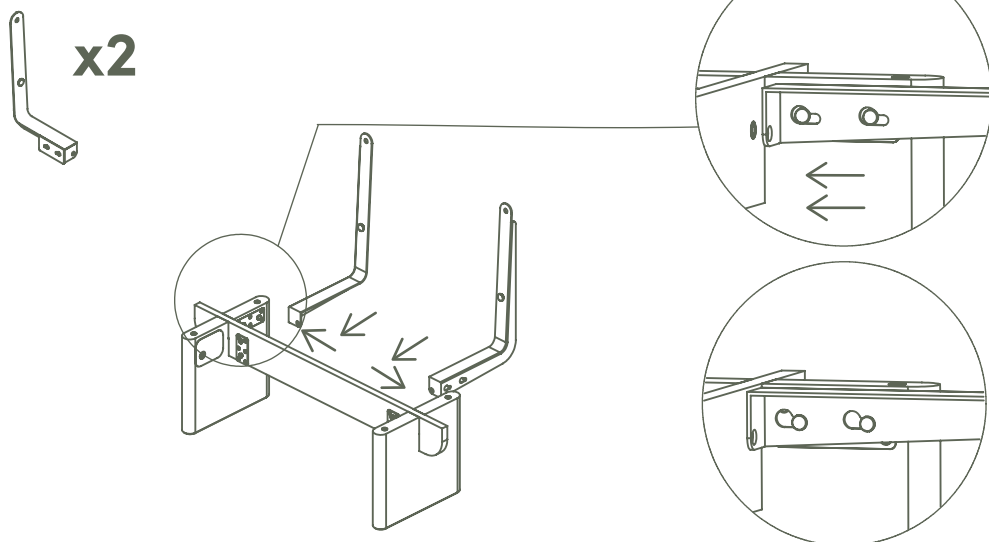

### 3. Fasten the bedhead brackets to the end support panel using the gumnuts

 **x2**

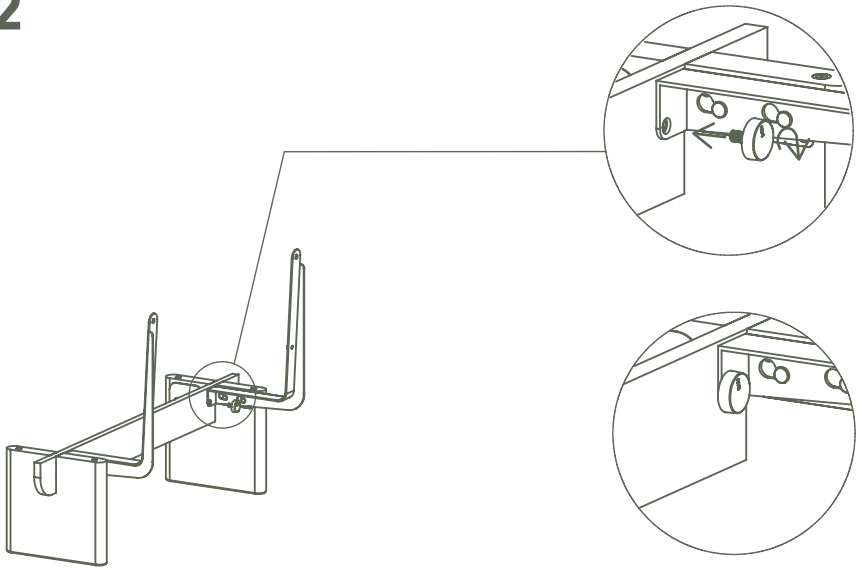

---

### 4. Slot the end panel to the foot-end legs

 **x2**

 **x1**

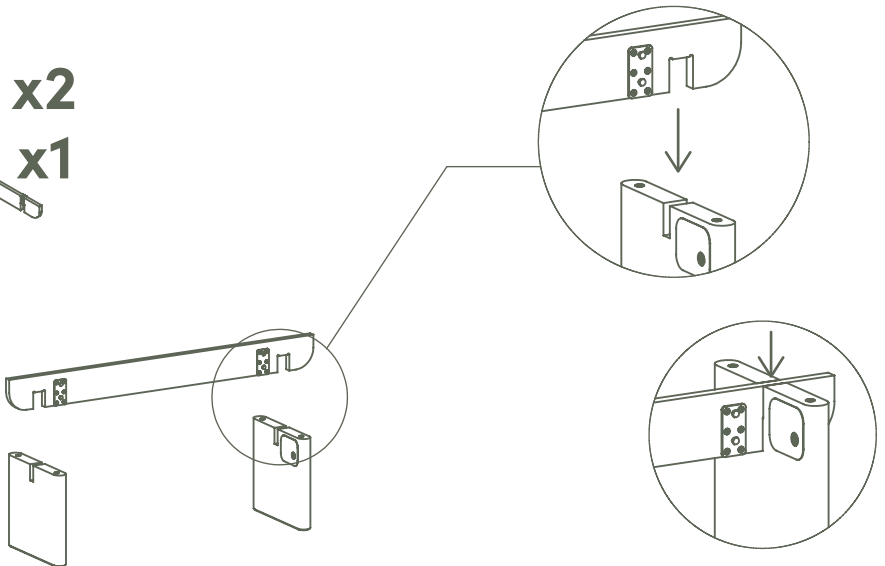

Ensure surface is flush

- 5.** Attach the side support panel using the metal brackets.  
Repeat for other side

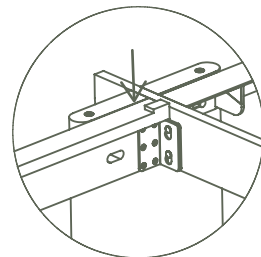
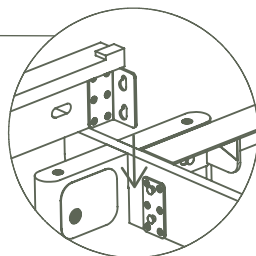
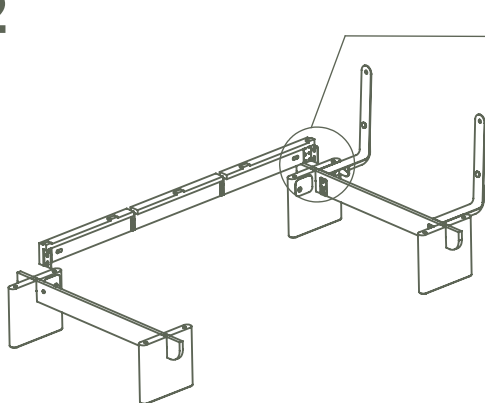

NOTE - Ensure felt pads are facing inwards

Ensure surface is flush

- 
- 6.** Fasten the side panel to the legs using the gumnuts

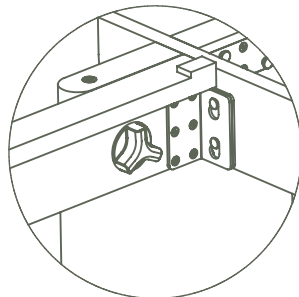
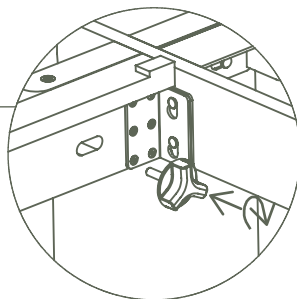
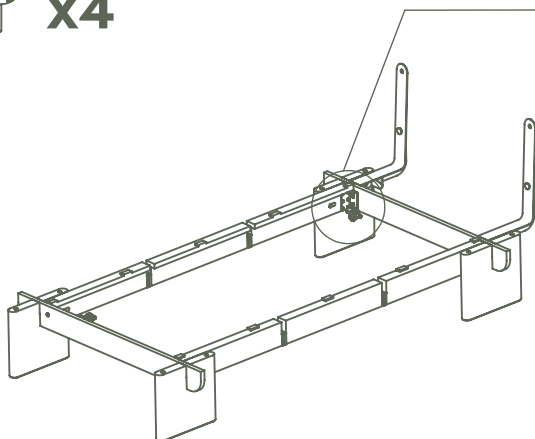

## 7. Slot the middle support frames to the side support panels

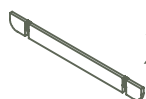

x2

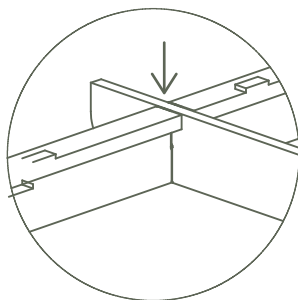
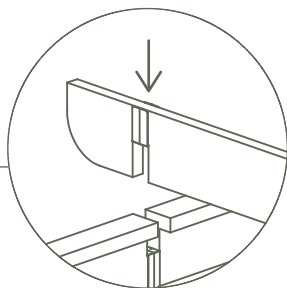
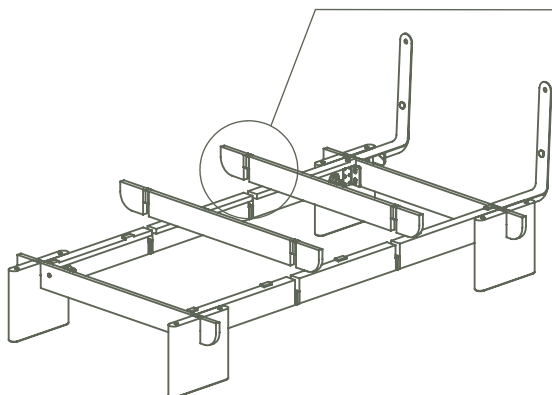

Ensure surface is flush

## 8. Lower side platforms into position and align the holes

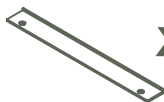

x2

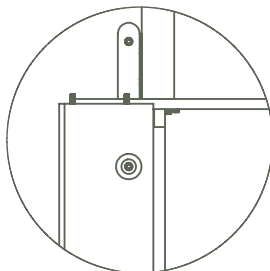
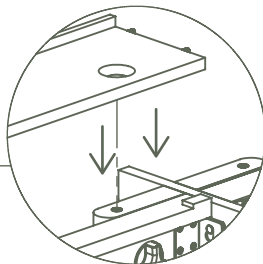
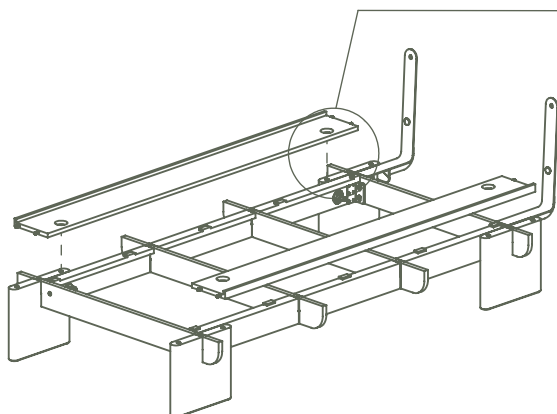

## 9. Loosely screw in the tapered gumnuts

 x4

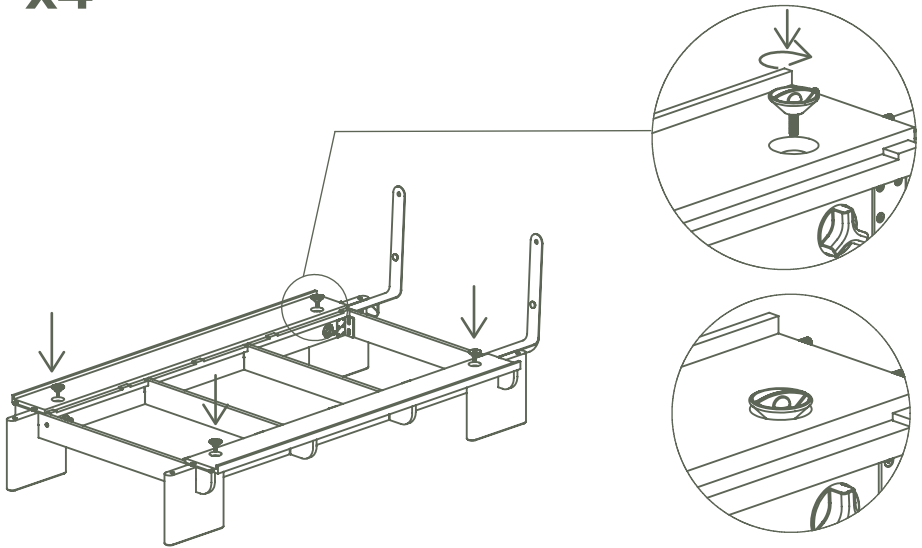

---

## 10. Attach the end platforms to the head and foot of the bed by aligning the dowels to the holes

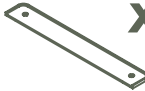
 x2

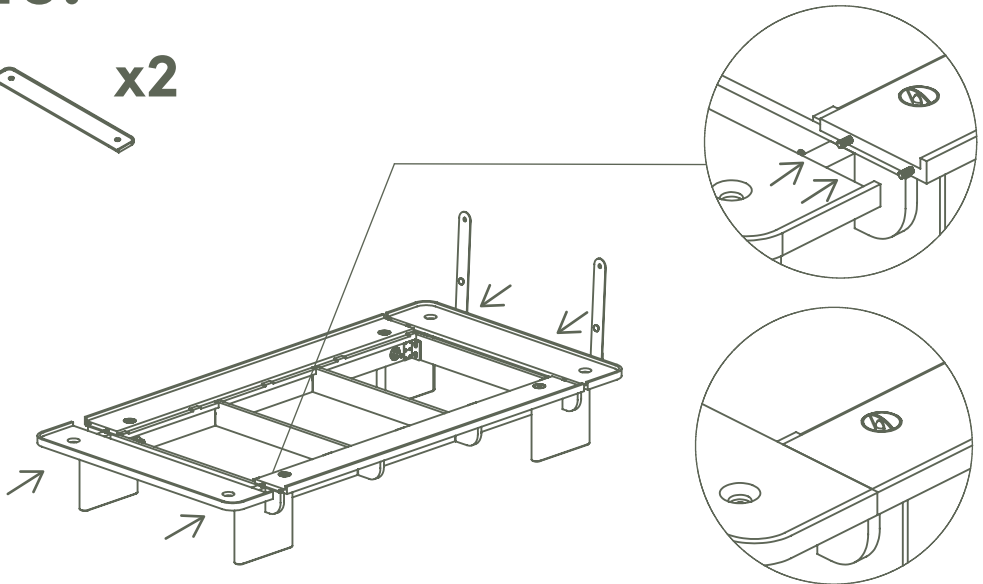



**11.** Fasten the remaining gumnuts firmly

 **x2**

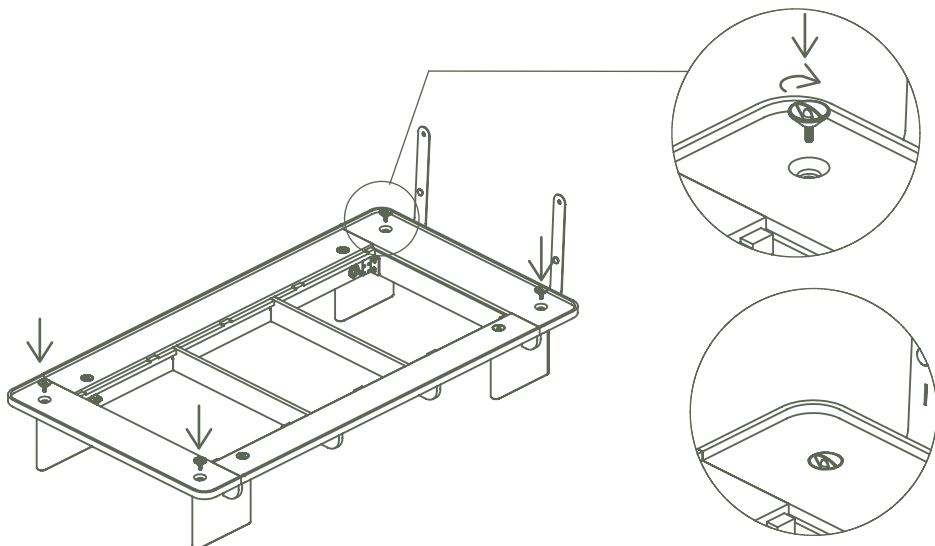

**12.** Mount the headboard onto the bedhead support by slotting in the bottom brackets and push down firmly

 **x1**

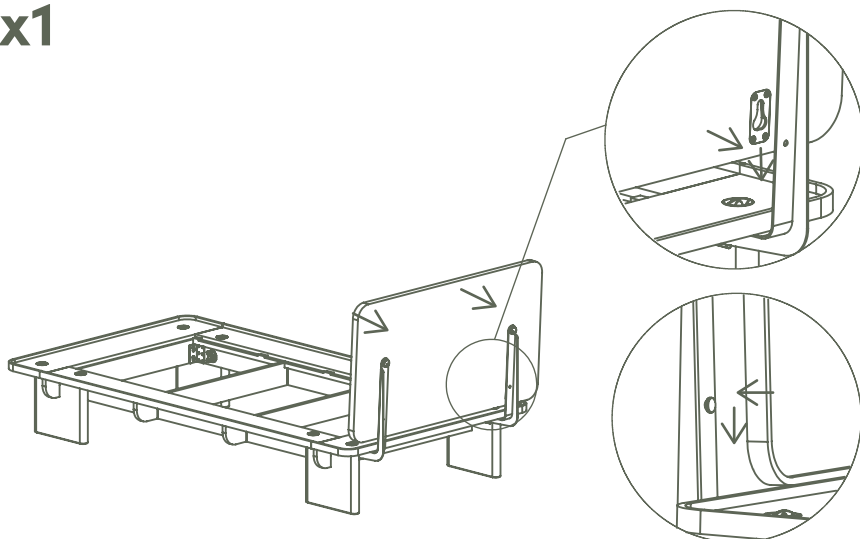

# 13.

Fasten the bedhead using the bedhead gumnuts provided

 **x2**

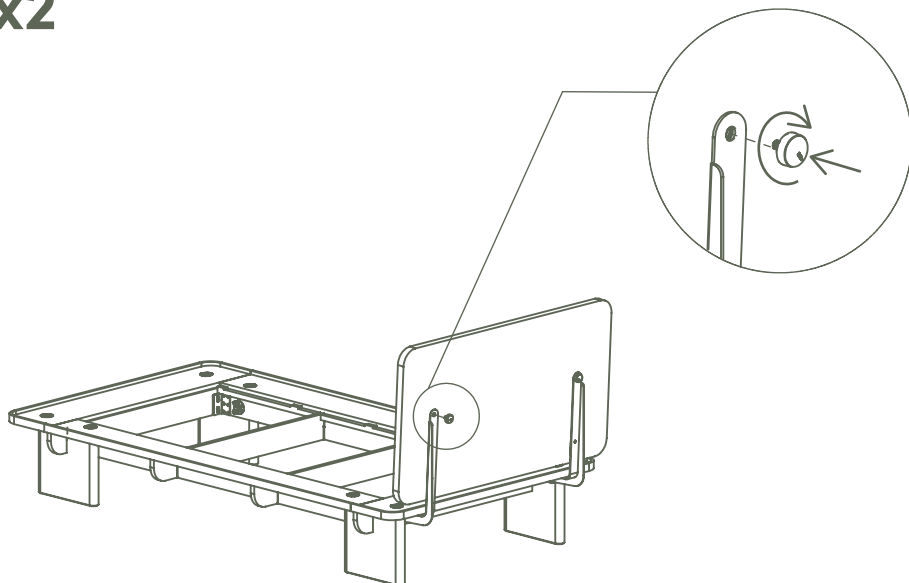

---

# 14.

Place the base platforms into the frame by aligning with the grooves on the side rail

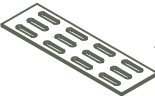
 **x4**

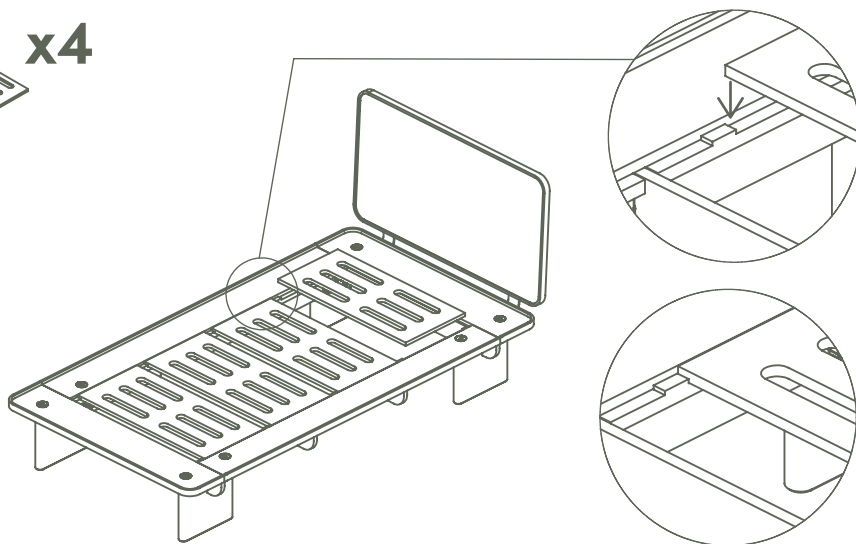

## Product Information and Care

### TIMBER

#### Regular Care (Weekly)

- Dust surface with a dry cloth or duster in the direction of the natural grain.
- Protect from direct sunlight.
- Do not place hot objects directly into the surface of the table.

#### Cleaning

- Treat spills as soon as possible, wipe down with clean dry cloth.
- Do not use abrasive cloths, concentrated detergents, silicon based wood polishes.

#### Good to Know

- Timber is a natural product and there will be variation in grain, colour and features such as knots. Over time the colour of timber will naturally change.

### USING THE BED

#### Weight Capacity

- Although we don't provide a specific weight limit on our beds because everyone uses them differently, we've put this bed through its paces with rigorous testing of key components up to 240kg static weight. This does not mean the bed can not take more weight.

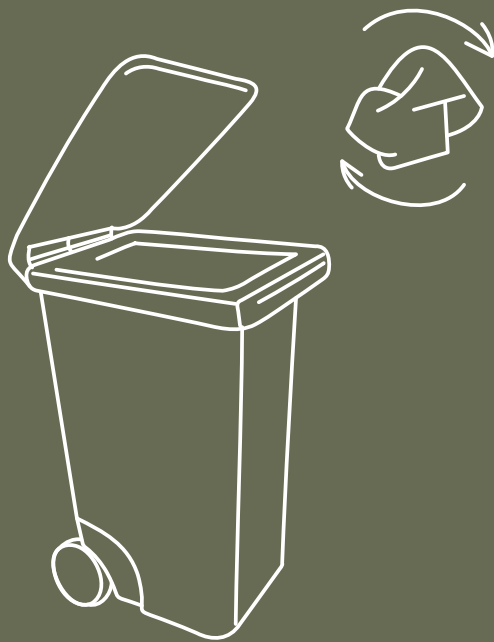

Don't forget to recycle.

**kóala**